

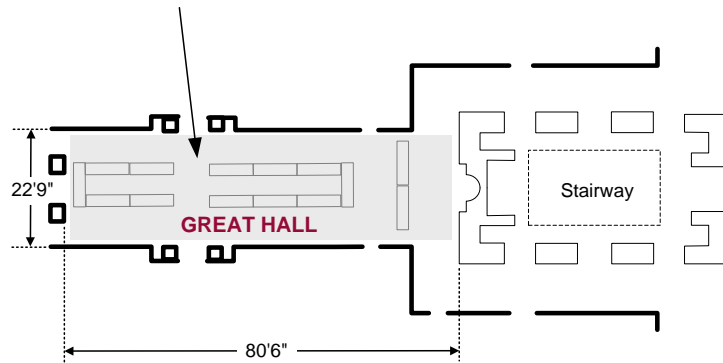

*Directions: The **Great Hall** area in the State Capitol is available for public events on a first-come-first-serve basis. This space must be reserved and an approved event application form is also necessary. To reserve this space and get the necessary form, call the Plant Management Service Line at 651.201.2300. Be sure you know the date you would like to use the space before you call.*

The **Great Hall** area is shaded in the drawing below. Dimensions are included to aid you in planning space usage. If event includes displays, they must be located in the center of the area, represented here by the light grid.



Great Hall location:

- State Capitol
- Ground floor
- West side

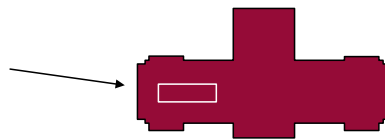

**STATE CAPITOL
GREAT HALL FLOOR PLAN**

